

# Plat of Survey

of

## Lot 11 of Villa Schweyer Subdivision,

located in the Southeast 1/4 of Section 21, Town 2 North, Range 16 East, Town of Delavan, Walworth County, Wisconsin.

Surveyed for: **Gerald & Maria Novak**  
605 Southpoint Drive  
Schaumburg, Illinois. 60172

c/o

### Johnson Construction

701 East Walworth Avenue  
Delavan, Wisconsin. 53115

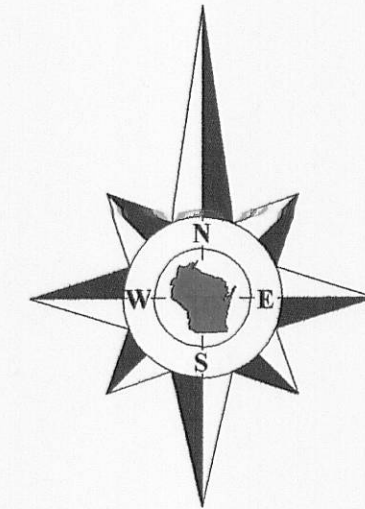

Bearings referenced to the plat of  
Villa Schweyer Subdivision.

Survey Date: April 6, 2011.  
Revisions:

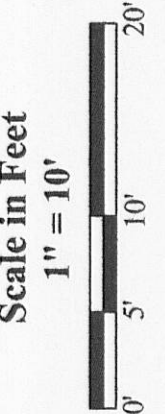

## Villa Del Aire Drive

(35' Wide)

(East 56')

East 55.99'

56.00'  
(56')

Lot 13

N0°07'12"W 53.06'  
(53')

24.0'  
7.1' Poured Concrete Foundation 7.2'

House  
No. 1900

Lot 11  
Tax Parcel  
FVS 00009

0.068 Acre  
2,971 Sq.Ft.

S0°07'42"E 53.06'  
(53')

Lot 9

Shed

Shed

9.1'  
Poured Concrete Foundation 9.1'

Shed

East 56.00'  
(East 56')

Tax Parcel  
FD 2100005

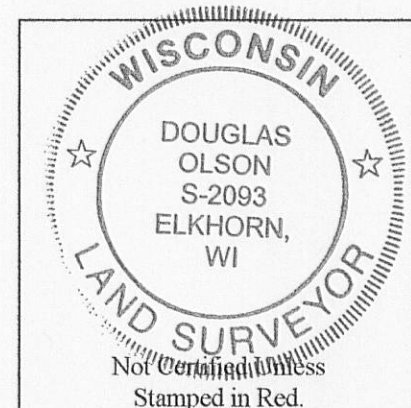

### Notes:

- 1) This survey plat is not certified unless signed and sealed in red ink.
- 2) This survey is subject to Wisconsin lien laws. This Plat of Survey is the notice of intent to file lien. Lien waiver required.

Copyright 2011 by Jensen & Olson Land Surveying, LLC.

All rights reserved. No part of this survey plat may be reproduced or transmitted in any form by any means - graphic, electronic, or mechanical, including photocopying, tracing, or information storage and retrieval systems - without permission in writing from Douglas G. Olson, Jensen & Olson Land Surveying, LLC.

I, Douglas G. Olson, Wisconsin Registered Land Surveyor, do hereby certify that this survey was performed by me, or under my direction in full compliance with the owner's/agent's instructions and Chapter A-E 7 of the Wisconsin Administrative Code "Minimum Standards for Property Surveys", and that this map is an accurate representation thereof to the best of my knowledge and belief.

Douglas G. Olson  
Wisconsin Registered Land Surveyor - 2093

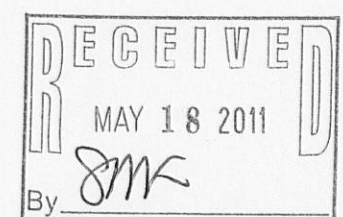

**Jensen & Olson Land Surveying, LLC**

45 South Wisconsin Street \* P.O. Box 322 \* Elkhorn, Wisconsin. 53121  
Telephone: (262) 723-3434 \* Facsimile: (262) 723-8044  
Email: jensen.olson@elknet.net

**Legend**  
Found Iron Pipe  
( ) Recorded Information  
X Utility Pole  
Asphalt Surface  
Concrete Surface

Sheet 1 of 1 Sheets  
Drawing Name: C:\d\201105-201105\Plat.dwg  
Job Reference Number  
2011.015

2011.015

FVS-9

216 - 4853